

How to clean equipment after use

Equipment must be discarded or cleaned according to manufacturer's directions before reuse.

1. Take apart bag and mask device for cleaning.
2. Wash all parts using a suitable detergent.
Rinse carefully with clean water to remove all remaining detergent. Leave to air dry.
3. Decontaminate by one of the following methods:
 - Steam autoclaving.
 - Chemical disinfection with activated glutaraldehyde.
Rinse thoroughly in clean water.
 - Boiling in water for at least 10 minutes.
4. Dry completely and keep clean until next use.

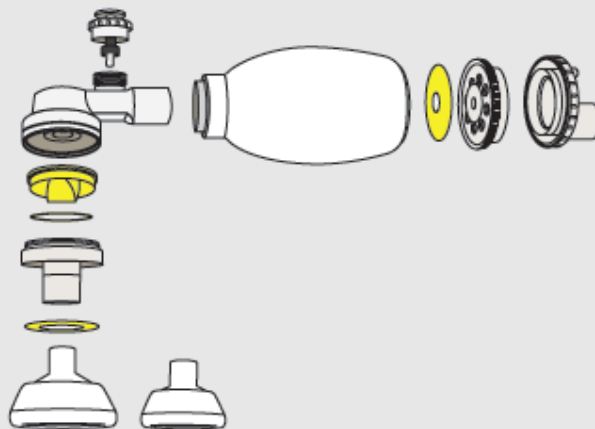

Helping Babies Breathe™
THE GOLDEN MINUTE™

American Academy of Pediatrics
DEDICATED TO THE HEALTH OF ALL CHILDREN™



© American Academy of Pediatrics, 2010
ISBN 978-1-58110-494-3
20-02639 Rev A